

HABITAT



IP30 Flush-fit distribution boxes with plastic door

The HABITAT series of flush-fit distribution boxes for hollow walls can be installed in prefabricated walls (such as plasterboard, wood, fibreboard, etc.) and in solid or brick walls.

They are intended for the tertiary and residential sector and adapt perfectly to any kind of ambience, perfectly integrating into the surrounding decoration.

IP
30

CE



HABITAT

HABITAT Technical Specifications

- **Degree of protection:** IP30.
- **Resistance to impact:** IK08.
- **Glow wire resistance:**
 - For hollow walls (30PH type):
 - 850 °C in flush-fit bases.
 - 650 °C in the rest of the set.
 - Brick walls (30EM type): 650 °C.
- **Ball pressure test:** 70 °C.
- **Ambient temperature range:** -25 °C / +40 °C.
- **Maximum operating voltage:** 1000 V AC/1500 V DC.
- **Double insulation:** Class II.

HABITAT Certifications

CE

Compliant with the Low Voltage Directive 2014/35/EU.
Standards: UNE-EN 62208 and UNE-EN 61439-1
(as applicable).

Intended for tertiary and residential sectors,
perfectly integrating into the surrounding decoration

HABITAT

IP30 flush-fit distribution boxes with plastic door



Product series

- 14, 28 and 42-module flush-fit enclosures with opaque window.
 - Version for hollow walls (30PH type).
 - Version for brick walls (30EM type).

Material

- Halogen-free plastic materials.
- Frame and opaque window: ABS RAL 9003 white.
- Base: PS RAL 7035 grey.

Supply

- Supplied in individual packaging. When several items are sent together, they are bundled together with transparent film. They are supplied with all the elements assembled, except for the ones supplied in the accessory bag.
- Accessory bag:
 - White module cover (6 modules).
 - Module identification strips.
 - 4x13 screws.
 - 4x10 screws.
 - 4x25 screws.
 - 4 hollow wall mounting elements (PH type).
 - Window clips.
 - Assembly instructions.

Available in two versions: for hollow walls and for brick walls



Base

- The flush-fit base is not a single part, but rather the top and bottom part are provided separately in order to facilitate the mounting and assembly of the distribution trunking. The top and bottom parts of the base have tabs that secure the trunking perfectly with flanges.
- The top and bottom covers are inserted on specific side guides and then secured with 4x13 screws. It has a grid that the installer can use as a guide in order to easily cut out the area required depending on the diameter and the layout of the distribution trunking. It is important to fit the top and bottom covers before flush-fitting in order to avoid possible base deformations.
- Four elements are provided to mount the base to the wall in PH (hollow wall) references. These elements will be placed in the guide channel and will rise as far as the wall, applying pressure to it, forming a kind of clamp with the wing of the base. The permitted range of wall widths for the mounting elements to work properly is from 6 to 30 mm.
- There are small holes along the wing of the base that can be used to easily mark the flush-fit gap.

- The base is totally reversible, which means that the installer does not need to worry about the direction in which they fit the enclosure into the wall.

Frame-base closing

- The frame is secured to the base by means of four 4x25 screws supplied in the accessory bag.
- The housing for tightening the screws on the base is rectangular in order to allow for possible deviations in the level of the flush-fitted base.
- The frame has a height of 15 mm all around the base to conceal possible flaws or damage caused during flush-fitting.
- In order to maintain the right distances from the rails to the top and bottom part of the enclosure, there is a "TOP" indication on the frame with an arrow to indicate the correct installation position.



Cover-frame closing

- The cover that protects the equipment and the wiring inside the enclosure is assembled by means of a practical and straightforward clipping system. In accordance with regulations, a tool must be used to reopen the cover once the frame has been clipped on.
- The enclosure has four sealable points.

Window

- RAL 9003 white opaque windows.
- Reversible horizontal 180° opening and closing.
- The window is closed by a clipping system.

DIN rail attachment

- A single rail is installed for the 14-base modules, while a frame is installed as standard format for 28 and 42-module sockets.
- The rails can be attached to the bottom of the base using the housings made for this purpose and screwed to the top part by means of 4x13 screws.
- They can also be secured to the frame by means of a clipping system on the ends of the rail. This can be complemented with two 4x10 screws that are supplied in the accessory bag.

HABITAT

IP30 flush-fit distribution boxes with plastic door

IP30 flush-fit distribution boxes. Hollow walls

Reference No.	No. of modules	External dimensions	Dimensions of the flush-fit gap	Weight	Power dissipation according to temperature increase °C P(W)*					Type	
					20	25	30	35	40		
		HEIGHT X WIDTH X DEPTH			KG						
PH14B0	1x14 DIN rail	277x385x100	243x335x85	1.64	10.8	13.5	16.2	18.9	21.6	30P14	
PH28B0	2x14 (28) DIN rail	427x385x100	393x335x85	2.63	16.6	20.8	25.0	29.1	33.3	30P28	
PH42B0	3x14 (42) DIN rail	597x385x100	563x335x85	4.05	23.2	29.0	34.8	40.6	46.5	30P42	

IP33 flush-fit distribution boxes. Brick walls

Reference No.	No. of modules	External dimensions	Dimensions of the flush-fit gap	Weight	Power dissipation according to temperature increase °C P(W)*					Type
					20	25	30	35	40	
		HEIGHT X WIDTH X DEPTH			KG					
EM14B0	1x14 DIN rail	277x385x100	243x335x85	1.58	10.8	13.5	16.2	18.9	21.6	30P14
EM28B0	2x14 (28) DIN rail	427x385x100	393x335x85	2.50	16.6	20.8	25.0	29.1	33.3	30P28
EM42B0	3x14 (42) DIN rail	597x385x100	563x335x85	3.60	23.2	29.0	34.8	40.6	46.5	30P42

HALOGEN-FREE PLASTIC MATERIALS

For the PH references the wall-mounting elements are included.

Neutral and earth bars included in all references.

Frame and window in RAL 9003 white ABS.

Base in grey RAL 7035 PS.

IP30 - Flush-fit.

PH: References for hollow walls. Glow wire resistance 850 °C.

* Calculations obtained according to the CEI 890:1997 standard (including Corrigendum 1998). Method of temperature-rise assessment by extrapolation for partially type-tested assemblies (PTTA) of low-voltage switchgear and control gear.



1x14 modules
PH/EM14B0

2x14(28) modules
PH/EM28B0

3x14(42) modules
PH/EM42B0

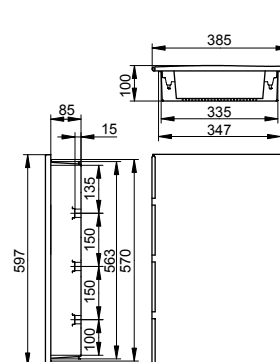
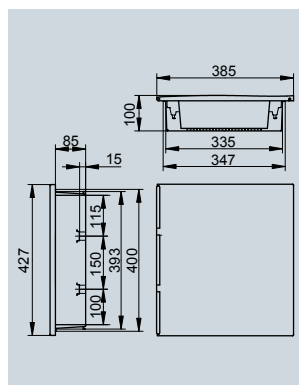
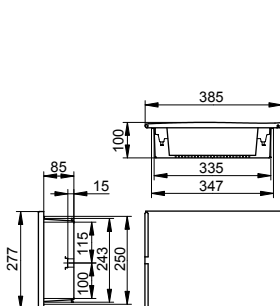

HABITAT Accessories



HOLLOW-WALL MOUNTING ACCESSORIES.

DIN RAIL 14/28/42 MODULES.

WHITE MODULE COVER.

MODULAR LIDS.

Neutral and earth bars

In some markets, the technical regulations governing installation require neutral and earth conductors to be connected to a common busbar. The Habitat series frames have a series of tabs at the top and the bottom where the necessary bar supports can be fitted. These enclosures have different tabs along the frame wall so that the installer can use the ones that best suit the wiring distribution in the unit.

All the references of this series are supplied with the neutral and earth bars included.

Neutral and earth bar structure

Ref.	Terminal I		Terminal II		Connectors	
	N	E	N	E	NEUTRAL	EARTH
22016	4+2	4+2	-	-	2x(4-10 mm ²)+4x(2.5-6 mm ²)	2x(4-10 mm ²)+4x(2.5-6 mm ²)
22017	8+2	8+2	8+2	8+2	1x(10-25 mm ²)+1x(4-10 mm ²)+8x(2.5-6 mm ²)	1x(10-25 mm ²)+1x(4-10 mm ²)+8x(2.5-6 mm ²)
22018	12+2	12+2	12+2	12+2	1x(10-25 mm ²)+1x(4-10 mm ²)+12x(2.5-6 mm ²)	1x(10-25 mm ²)+1x(4-10 mm ²)+12x(2.5-6 mm ²)

HABITAT Accessories

Miscellaneous	Ref.
DIN rail 14/28/42	92765
White module cover (6 mod.)	77600
Hollow wall accessory bag	94037
Covers	Ref.
Cover for 30P14	74702
Cover for 30P28	74712
Cover for 30P42	74722

Neutral and earth bars	Ref.
Support + neutral and earth bars (4+2 entries)	22016
Support + neutral and earth bars (8+2 entries)	22017
Support + neutral and earth bars (12+2 entries)	22018
Opaque windows	Ref.
14 modules	76902
28 modules	76912
42 modules	76922

DOMOS-K



Flush-fit mechanisms and junction boxes (Hollow walls)

Mechanism and junction boxes specially designed to be installed in prefabricated walls (such as plasterboard, wood, fibreboard, etc.). Manufactured with high-quality and high-strength materials that make installation and flush-fitting easy. Designed for circuits whose voltage is not greater than 400 V in alternating current and a maximum current of 16 A.