

SOLUTION FOR OUTDOOR APPLICATIONS



ETA QUALITY, FOR OUTDOOR

Thanks to the specific constructive concept, high quality materials and resistant finishes, the range of outdoor solutions E VIS provides the perfect protection of the framework internal components by environmental factors, extreme temperatures, direct sunlight, harsh environment, vandalism and atmospherical, chemical and mechanical agents.

For these reasons, E VIS product design provides an exceptional protection for your outdoor applications.

BENEFITS

New manufacturing concepts	Innovation
Natural ventilation	Functionality
Resistant materials and finishes for outdoor applications	Strength
Quick assembly and easy wiring	Easiness
Anti-vandalism design and protection of the inner components	Safety

Outdoor



evis

SOLUTIONS FOR OUTDOOR APPLICATIONS

FEATURES

- 1 Available in two versions: single-wall or double-wall with coverings.
- 2 Available in two materials: steel sheet and aluminium alloy.
- 3 ETA special finishing cycle: paint-based primer with deposition by cataphoresis with epoxy resin and finishing using thermosetting powders.
- 4 Monobloc cabinets with a vandal-resistant silhouette that is inaccessible when the door is closed.
- 5 Rain canopy screwed on the structure.



- 6 Door provided with a locking system with key and with the possibility to install different inserts or lockable closures.
- 7 Natural ventilation around the monobloc cabinet, due to the "double-wall" system of the side and rear panels, the ventilated roof and the plinth.
- 8 Quick and easy installation wiring, combined with the maximum safety and security.
- 9 It can be equipped internally with ETA standard accessories.

Outdoor





INNOVATION

Innovative product concept.



DESIGN

Thanks to the custom design, the side covers are assembled without the aid of screws.

Outdoor

S
PLUS
R

FLEXIBILITY

Possibility to design solutions with special dimensions, different finishes, special insulations, silicone seal or completely customised solutions according to customers' requirements.



THERMAL MANAGEMENT

Double-layer front door and ventilation openings on the roof for a simple thermal management of the solution.



FUNCTIONALITY

Only 3 screws to assemble the hinged roof and fix the side covers to the monobloc structure.



STRENGTH AND SAFETY

With the door closed there are no points of access from the outside. Locking system with key.



EASINESS

Large cable entry and quick assembly of the front plinth crosspiece for an easy wiring.



IMPROVEMENTS

- Reversible door
- plinth side crosspieces for an easy mounting
- lifting system with 2 eyebolts
- plate can be recessed flush with the uprights
- silicone foam seal supplied as a standard.

CHARACTERISTICS

- Monobloc enclosure, roof, door and rear panel manufactured from aluminium alloy AlMg3 or sheet steel.
- welded monobloc structure with removable rear panel
 - roof with ventilation slots and screwed to the monobloc enclosure
 - exclusive frontal access with a door provided with a two-component silicone foam seal, 3 points lever-operated locking system and key lock
 - 40 mm high rain canopy with a 20 mm overhang on all sides
 - removable and screwed cable entry plates
 - available with the double door for L=1200 mm
 - plinth H=100/200 available with front blank or ventilated crosspieces, to be ordered separately.

PAINT FINISH

ETA special finishing cycle: paint-based primer with deposition by cataphoresis with epoxy resin and finishing using thermosetting powders. Colour: RAL 7035 smooth finish.



PROTECTION RATING

- IP56 (single door) and IP55 (double door) complying with IEC EN62208; EN62262
- protection degree guaranteed by the two-component silicone foam seal
- impact resistance IK 10 complying with IEC EN62208; EN62262.



RAL 7035L



Accessories, see page 260.

Outdoor

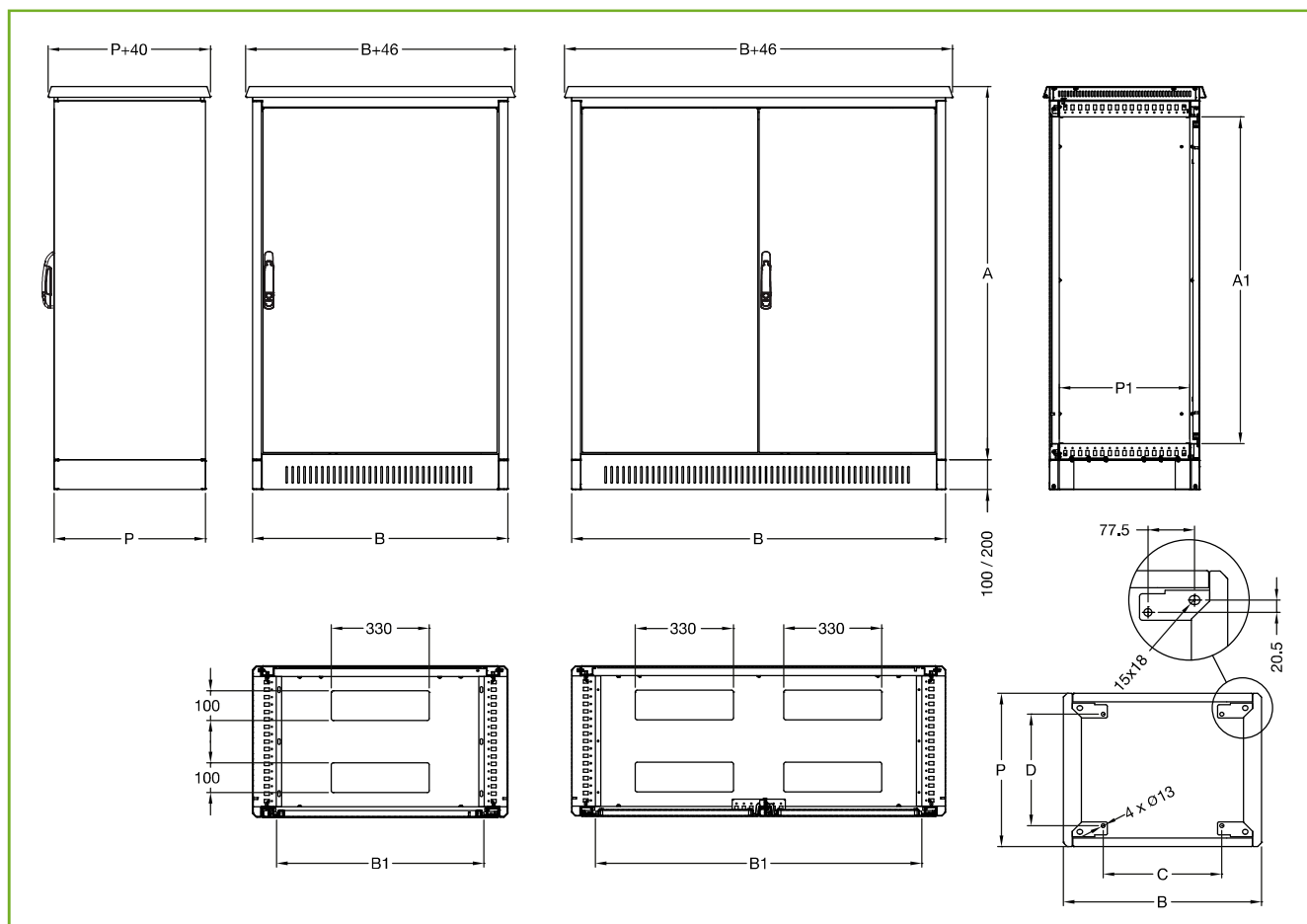

DIMENSIONAL SPECIFICATIONS

E VIS CODE	DIMENSIONS			CABINET DIMENSIONS			AVAILABLE SPACE		
	WIDTH	HEIGHT	DEPTH	B	A	P	B1	A1	P1
EVIS060804SA	600	800	400	660	858	410	500	700	340
EVIS061204SA	600	1200	400	660	1258	410	500	1100	340
EVIS061205SA	600	1200	500	660	1258	510	500	1100	440
EVIS061404SA	600	1400	400	600	1458	410	500	1300	340
EVIS080804SA	800	800	400	860	858	410	700	700	340
EVIS081204SA	800	1200	400	860	1258	410	700	1100	340
EVIS081205SA	800	1200	500	860	1258	510	700	1100	440
EVIS081404SA	800	1400	400	860	1458	410	700	1300	340
EVIS120804SA	1200	800	400	1260	858	410	1100	700	340
EVIS121204SA	1200	1200	400	1260	1258	410	1100	1100	340
EVIS121205SA	1200	1200	500	1260	1258	510	1100	1100	440
EVIS121404SA	1200	1400	400	1260	1458	410	1100	1300	340

Codes are referring to the single-wall solution manufactured from aluminium alloy. To order the single-wall sheet steel version, replace the suffix "A" with the suffix "M" (i.e.: EVIS060804SM).

Further dimensions available upon request.

Outdoor



RAL 7035L



Accessories, see page 260.

Outdoor

IMPROVEMENTS

- Reversible door
- plinth side crosspieces for an easy mounting
- lifting system with 2 eyebolts
- plate can be recessed flush with the uprights
- silicone foam seal supplied as a standard.

CHARACTERISTICS

- Monobloc enclosure, roof, door, rear panel and covers manufactured from aluminium alloy AlMg3 or sheet steel.
- welded monobloc structure with removable rear panel and provided with external covers
 - rear and side covers fixed to the monobloc structure without the aid of screws, with a pre-defined mounting sequence and a logical system of joints
 - hinged roof with ventilation slots frontally screwed to the frame of the monobloc enclosure
 - exclusive frontal access with a double-wall door provided with a two-component silicone foam seal, 3 points lever-operated locking system and key lock
 - 40 mm high rain canopy with a 20 mm overhang on all sides
 - removable and screwed cable entry plates
 - available with the double door for L=1200 mm
 - plinth H=100/200 available with front blank or ventilated crosspieces, to be ordered separately

PAINT FINISH

ETA special finishing cycle: paint-based primer with deposition by cataphoresis with epoxy resin and finishing using thermosetting powders. Colour: RAL 7035 smooth finish.



PROTECTION RATING

- IP56 (single door) and IP55 (double door) complying with IEC EN62208; EN62262
- protection degree guaranteed by the two-component silicone foam seal
- impact resistance IK 10 complying with IEC EN62208; EN62262.

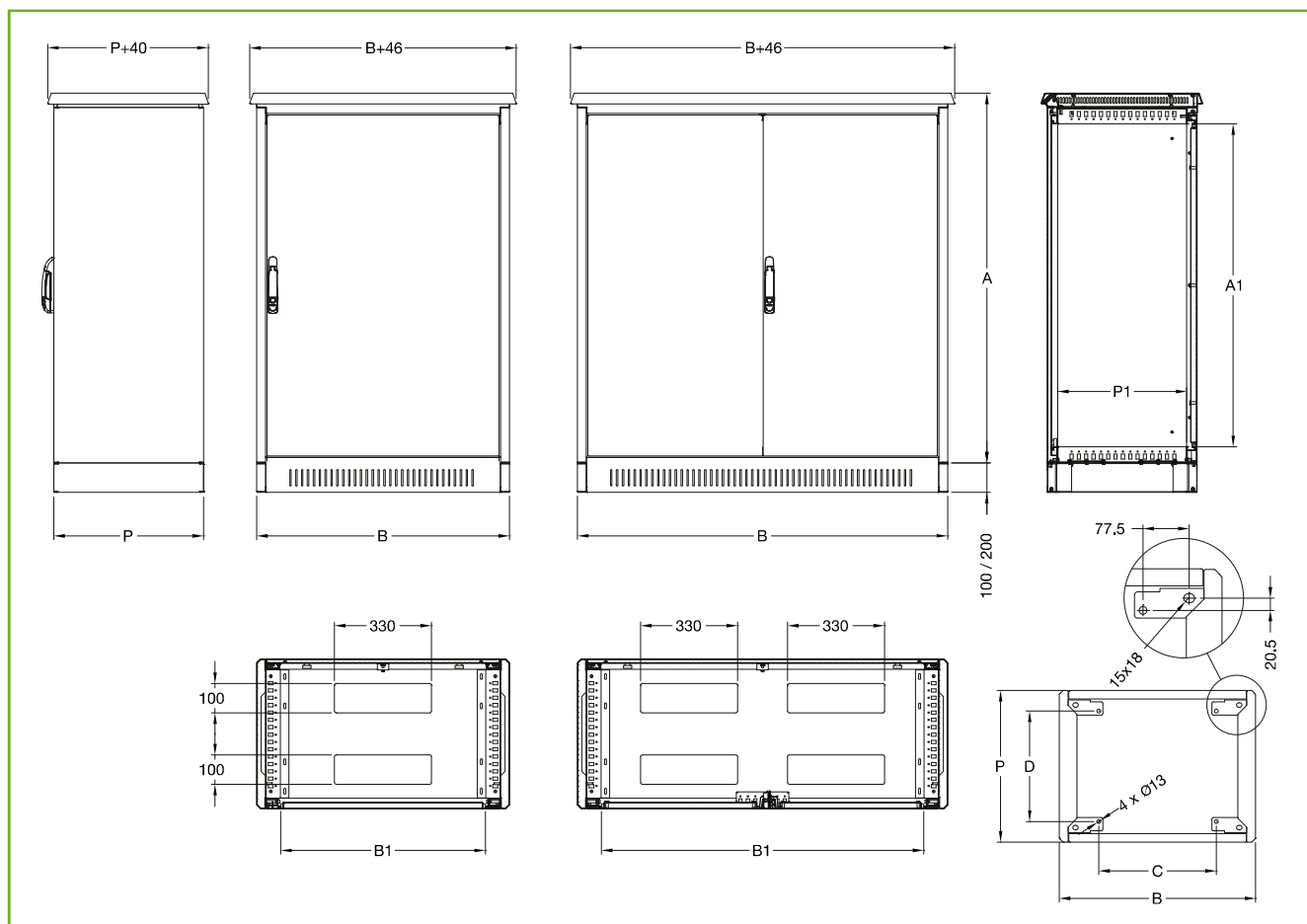

DIMENSIONAL SPECIFICATIONS

E VIS CODE	DIMENSIONS			CABINET DIMENSIONS			AVAILABLE SPACE		
	WIDTH	HEIGHT	DEPTH	B	A	P	B1	A1	P1
EVIS060804DA	600	800	400	660	858	410	500	700	340
EVIS061204DA	600	1200	400	660	1258	410	500	1100	340
EVIS061205DA	600	1200	500	660	1258	510	500	1100	440
EVIS061404DA	600	1400	400	600	1458	410	500	1300	340
EVIS080804DA	800	800	400	860	858	410	700	700	340
EVIS081204DA	800	1200	400	860	1258	410	700	1100	340
EVIS081205DA	800	1200	500	860	1258	510	700	1100	440
EVIS081404DA	800	1400	400	860	1458	410	700	1300	340
EVIS120804DA	1200	800	400	1260	858	410	1100	700	340
EVIS121204DA	1200	1200	400	1260	1258	410	1100	1100	340
EVIS121205DA	1200	1200	500	1260	1258	510	1100	1100	440
EVIS121404DA	1200	1400	400	1260	1458	410	1100	1300	340

Codes are referring to the double-wall solution manufactured from aluminium alloy. To order the double-wall sheet steel version, replace the suffix "A" with the suffix "M" (i.e.: EVIS060804DM).

Further dimensions available upon request.

Outdoor



FRONT INSERTED MOUNTING PLATE EVPA

Manufactured from sendzimir sheet steel.

 To be ordered separately: mounting accessories WTAC-002.

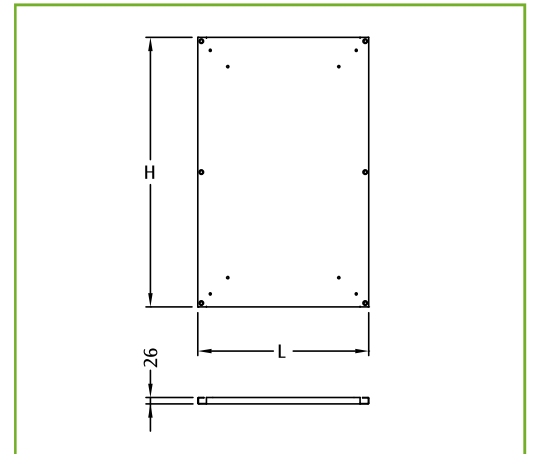

MOUNTING PLATE

EVPA CODE	CABINET DIM.		M. PLATE DIM.	
	B	A	L	H
EVPA-060080	600	800	485	680
EVPA-060120	600	1200	485	1080
EVPA-060140	600	1400	485	1280
EVPA-080080	800	800	685	680
EVPA-080120	800	1200	685	1080
EVPA-080140	800	1400	685	1280
EVPA-120080	1200	800	1085	680
EVPA-120120	1200	1200	1085	1080
EVPA-120140	1200	1400	1085	1280

Outdoor



MODULAR PLINTH EVZE

CHARACTERISTICS

Front and lateral crosspieces with integrated corners manufactured from aluminium alloy AlMg3 or sheet steel.

PAINT FINISH

ETA special finishing cycle: paint-based primer with deposition by cataphoresis with epoxy resin and finishing using thermosetting powders. Colour: RAL 7035 smooth finish.



SUPPLY

The plinth is composed by:

- two lateral blank crosspieces with integrated corners
- two front blank or ventilated crosspieces.

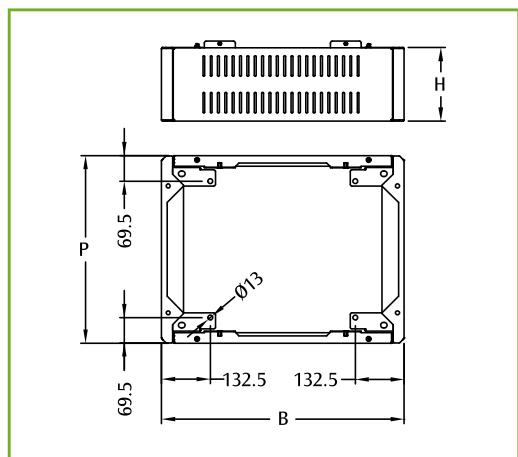

LATERAL CROSSPIECES WITH CORNERS

EVZE CODE	DESCRIPTION	P
EVZE-T0400A	LATERAL CROSSPIECES WITH INTEGRATED CORNERS H=100	410
EVZE-T0500A	LATERAL CROSSPIECES WITH INTEGRATED CORNERS H=100	510

FRONT CROSSPIECES

EVZE CODE	DESCRIPTION	B
EVZE-T0600A	FRONT BLANK CROSSPIECES H=100	660
EVZE-T0800A	FRONT BLANK CROSSPIECES H=100	860
EVZE-T1200A	FRONT BLANK CROSSPIECES H=100	1260

Codes are referring to the plinth in aluminium alloy.

To order the plinth in the sheet steel version, replace the suffix "A" with the suffix "M" (i.e.: EVZE-T0400M).

To order the frontal crosspieces with ventilation slots, add the suffix "V" to the code (i.e.: EVZE-T0400AV or EVZE-T0400MV).

To order crosspieces with H=200, add the suffix "D" to the code (i.e.: EVZE-T0400AD or EVZE-T0400AVD).



19" RAILS AEMK

Designed for assembling 19" items or modular equipment on DIN rails.

CHARACTERISTICS

Manufactured from zinc sheet steel.

SUPPLY

Includes nr. 2 pieces.

19" RAILS		
AEMK CODE	CABINET HEIGHT	HE
AEMK150800	800	15
AEMK241200	1200	24
AEMK291400	1400	29



BRACKETS AEP0070

Brackets manufactured from zinc sheet steel, used for the mounting of 19" uprights on cabinets W=600 mm.

SUPPLY

Includes nr. 4 pieces.



WIDTH RAILS AEP0098

Rails for the mounting of 19" rack uprights (AEMK, AERL, AERC) on E VIS cabinets with W=800 mm. Manufactured from sendzimir sheet steel.

SUPPLY

Includes nr. 2 pieces.

WIDTH RAILS	
AEP CODE	WIDTH
AEP0098	800

Outdoor

To be ordered separately AEP0070 (nr. 4 pieces) for the assembly of 19" rack rails.

EYEBOLTS WTGS-004

CHARACTERISTICS

Zinc-passivated M12 lifting eyebolts.

SUPPLY

Includes nr. 2 pieces with mounting accessories.

DOOR STOP WTFP-008

Allows the mechanical stop of the door at 95°.

SUPPLY

Includes 1 piece with accessories.

WE LOCKING SYSTEMS

For WE locking systems and inserts that are different from the standard solutions with the key, see page 59.



THERMAL MANAGEMENT

Outdoor applications, that are exposed to different temperature gradients and to a continuous solar irradiation, need a good conditioning to constantly ensure the proper functioning of the electrical and electronic equipment installed.

In order to handle these issues in an appropriate way, in addition to the standard items for ventilation and heating, we offer a choice of specific outdoor cooling unit, to be installed inside or outside the cabinet and a wide range of accessories (anti-condensation heaters etc.)

 For further information, see Thermal Management section (page 303).

Outdoor

Cable glands for outdoor applications are available (see pages 267 and 268).



For your special projects, we offer a wide range of tested cable glands that have been designed to guarantee safe and performing solutions!

From simplified to complex and harsh applications areas, a specific solution for the cabling is available:

- 1 Generic industrial business
- 2 Transportation: high vibrating loads and high levels of chemical pollution
- 3 Marine industry: specific requirements
- 4 Electronically-controlled substations: EMC requirements
- 5 Food industries: anti-bacterial substances for high level of safety
- 6 Chemical industry and off-shore: potentially explosive atmospheres

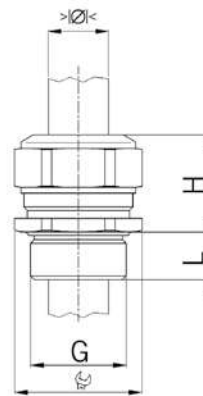

STAINLESS STEEL CABLE GLANDS

Material: stainless steel
 Seal: TPE for A2; FPM for A4
 O-ring: NBR for A2; FPM for A4
 Strain relief: Ver. A
 Temperature range: -40° / + 100°C for A2; -40° / + 200°C for A4
 Protection rating: IP 68 up to 10 bar

STAINLESS STEEL CABLE GLANDS
 Long entry thread metric, two-piece sealing insert not overall length insulated

G	>Ø< min mm	>Ø< max mm	 mm	H mm	L mm	CODE (STAINLESS STEEL A2)	CODE (STAINLESS STEEL A4)	M.o.q.
M16x1.5	6.0	10.5	19	20	10	WP17105X2	WP17105X4	50
M20x1.5	8.0	15.0	24	21	10	WP20150X2	WP20150X4	50
M25x1.5	12.5	20.5	30	25	11	WP25205X2	WP25205X4	25
M32x1.5	17.0	25.5	36	28	13	WP32255X2	WP32255X4	25
M40x1.5	24.0	33.0	46	31	13	WP40330X2	WP40330X4	10
M50x1.5	33.0	42.0	55	34	14	WP50420X2	WP50420X4	10
M63x1.5	40.0	52.0	70	37	14	WP63520X2	WP63520X4	5

 Stainless steel A4 is acid-resistant and suitable for high temperatures.

Harsh environments



CABLE GLANDS FOR EMC APPLICATIONS

This range guarantees full control during installation and compensates for tolerances in shielding thicknesses to make a secure screened tap connection. The spring system provides for a very good contact of partially stripped shielding cables equally as well as for the contact of completely exposed cable shields which can be routed further.

Material: nickel-plated brass
 Contact spring: steel 1.4310
 Seal: TPE
 O-ring: NBR
 Strain relief: according to IEC EN 6244, Ver. A
 Temperature range: -40° / + 100°C
 Protection rating: IP 68 / IP 69K

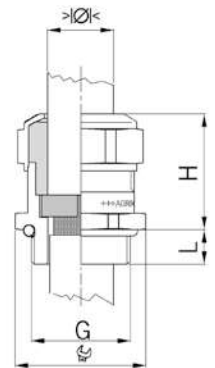

CABLE GLANDS FOR EMC APPLICATIONS

Two-piece sealing insert, not overall length insulated

G	>Ø< min mm	>Ø< max mm	 mm	H mm	L mm	Code (short entry thread metric)	L mm	CODE (long entry thread metric)	M.o.q.	NOTE
M12x1.5	3.5	5.0	15	22	5	WP12050EC	10	WP12050EL	50	1
M12x1.5	5.0	6.5	15	22	5	WP12065EC	10	WP12065EL	50	1
M16x1.5	6.0	10.5	18	25	5	WP17105EC	10	WP17105EL	50	-
M20x1.5	8.0	15.0	24	27	6	WP20150EC	10	WP20150EL	50	-
M25x1.5	12.5	20.5	30	33	7	WP25205EC	11	WP25205EL	25	-
M32x1.5	17.0	25.5	36	33	8	WP32255EC	13	WP32255EL	25	-
M40x1.5	24.0	33.0	46	38	8	WP40330EC	13	WP40330EL	10	2
M50x1.5	33.0	42.0	55	42	9	WP50420EC	14	WP50420EL	10	2
M63x1.5	40.0	52.0	70	42	10	WP63520EC	14	WP63520EL	5	2

1 - one piece sealing insert
 2 - approval pending

FURTHER OPTIONS AVAILABLE

CABLE GLANDS FOR FOOD INDUSTRY

Ultra-flat cable glands offering very little surface for contamination; manufactured from stainless steel A2, temperature range -40°/+200° and protection rating IP68. Available with or without EHEDG certification.

CABLE GLANDS FOR OUTDOOR APPLICATIONS

Ultra-flat cable glands inhibiting any manipulation from outside, with no contact surface for interference. Manufactured from nickel-plated brass, temperature range -40°/+100° and protection rating IP68.

CABLE GLANDS FOR POTENTIALLY EXPLOSIVE ATMOSPHERES

Cable glands designed for Ex d IIC and increased safety Ex e II applications; manufactured in nickel-plated brass (stainless steel version available on request), temperature range -60°/+100°, protection rating IP68.
 Certificate: EC-Type PTB 10 ATEX 1034X / IECEx PTB 12.0055
 Certificate: SEV 15 ATEX 0152X / IECEx SEV 15.0019X



Harsh environments

For any further request, do not hesitate to contact our Sales team.